

# LED T8 Tube - Bypass Retrofit

ELYT8G2 Series



## Installation Instructions

Please read through this installation guide before beginning the installation of Energetic Lighting ELYT8G2 Series LED T8 tube.

This LED tube is a retrofit kit and requires the rewiring of the Luminaire prior to installation. Do not install this LED tube into the fixture until all retrofit instruction steps have been completed.

### Cautions and Warnings

**WARNING:** Risk of fire or electric shock. LED Retrofit Kit installation requires knowledge of luminaires electrical systems. If not qualified, do not attempt installation. Contact a qualified electrician.

**WARNING:** Risk of fire or electric shock. Install this kit only in the luminaires that have the construction features and dimensions shown in the photographs and/or drawings and where the input rating of the retrofit kit does not exceed the input rating of the luminaire.

**WARNING:** Risk of fire or electric shock. The electrical rating of this product is 120-277 Vac, the installer must determine whether they have 120-277 Vac at the luminaire before installation.

**WARNING:** RISK OF FIRE OR ELECTRIC SHOCK. DO NOT ALTER, RELOCATE, OR REMOVE WIRING, LAMP HOLDERS, POWER SUPPLY, OR ANY OTHER ELECTRICAL COMPONENT.

THE RETROFIT ASSEMBLY IS ACCEPTED AS A COMPONENT OF A LUMINAIRE WHERE THE SUITABILITY OF THE COMBINATION SHALL BE DETERMINED BY UL OR AUTHORITIES HAVING JURISDICTION.

**WARNING:** To avoid potential fire or shock hazard, do not use this retrofit kit in luminaires employing shunted bi-pin lampholders. Note: Shunted lampholders are found only in fluorescent luminaires with Instant-Start ballasts. Instant-start ballasts can be identified by the words "Instant Start" or "I.S." marked on the ballast. This designation may be in the form of a statement pertaining to the ballast itself, or may be combined with the marking for the lamps with which the ballast is intended to be used, for example F40T12/IS. For more information, contact the LED luminaire retrofit kit manufacturer. See figure below.

**WARNING:** To prevent wiring damage or abrasion, do not expose wiring to edges of sheet metal or other sharp objects.

Do not make or alter any open holes in an enclosure of wiring or electrical components during kit installation.

Installers should not disconnect existing wires from lamp holder terminals to make new connections at lamp holder terminals. Instead installers should cut existing lamp holder leads away from the lamp holder and make new electrical connections to lamp holder lead wires by employing applicable connectors.

**NOTE:** If installing multiple LED T8 tubes into a single fixture, the maximum number of tubes per fixture is 4.

MIN. LUMINAIRE DIMENSIONS 123(L) X 60(W) X 9.5(H) cm

SUITABLE FOR DAMP LOCATIONS  
NOT FOR USE WITH DIMMERS.  
SUITABLE FOR USE IN TOTALLY ENCLOSED LUMINAIRES.  
THIS DEVICE IS NOT INTENDED FOR USE WITH EMERGENCY EXITS.

**WARNING:** RISK OF ELECTRIC SHOCK - DISCONNECT POWER AT THE SOURCE BEFORE INSTALLATION.

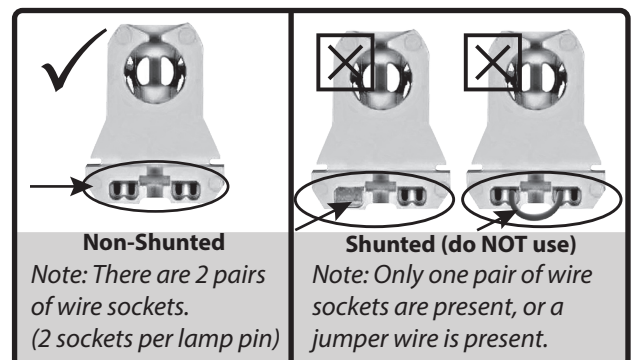

# LED T8 Tube - Bypass Retrofit

ELYT8G2 Series



## Wiring and Installation

1. Switch off power supply before installation. Remove diffuser (if applicable) and all fluorescent tube lamps from luminaire.

Identify which ballast and wiring setup is used in the luminaire as shown in Fig. 1 and Fig. 2.

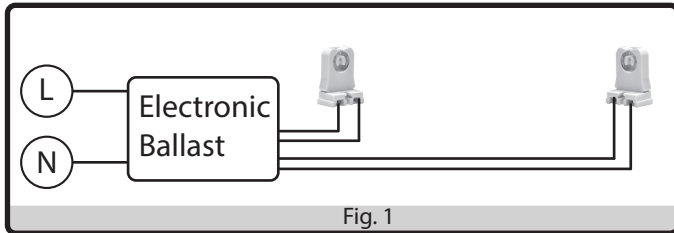

Fig. 1

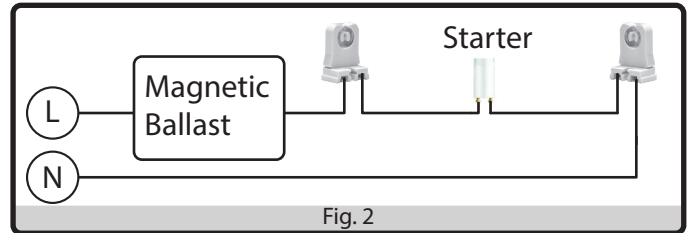

Fig. 2

2. Cut all wires leading into and out of the ballast and starter (if applicable), as shown in Fig. 3 and Fig. 4.

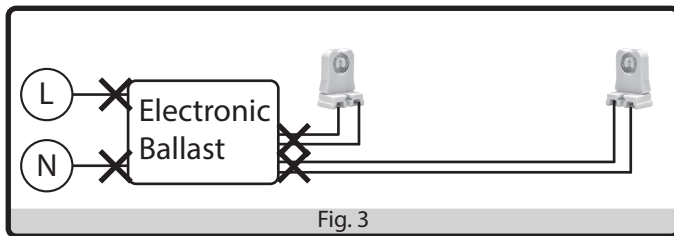

Fig. 3

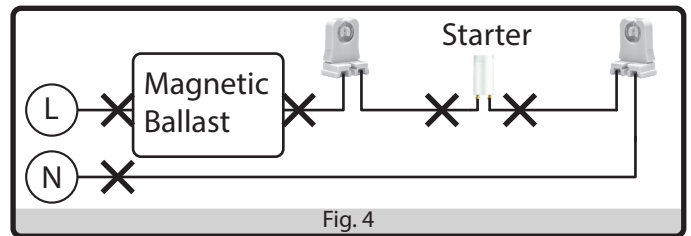

Fig. 4

3. Connect the input supply lines to the lampholder as shown in Fig. 5.

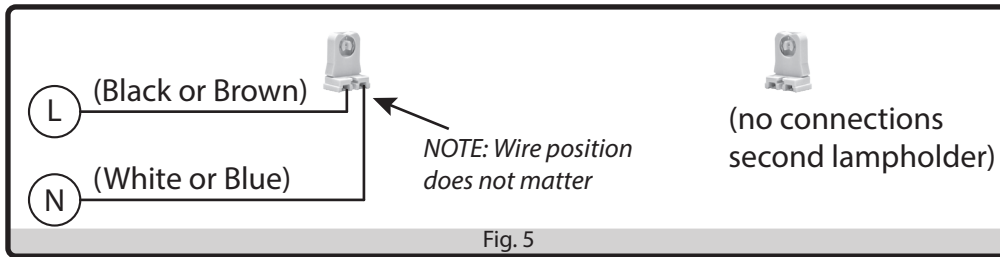

Fig. 5

4. Apply the retrofit warning label on fixture in a location that will be readily visible during normal maintenance.

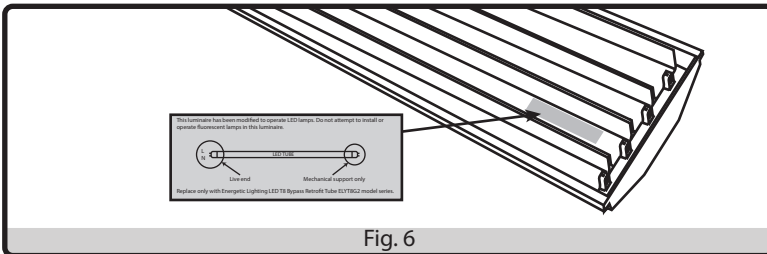

Fig. 6

5. Locate the end of the LED T8 Tube where the "LIVE END" label is printed and ensure that this end of the tube is plugged into the LIVE lampholder socket as shown in Fig. 6. Turn the bulb in the direction such that the heat sink strip faces up into the fixture.

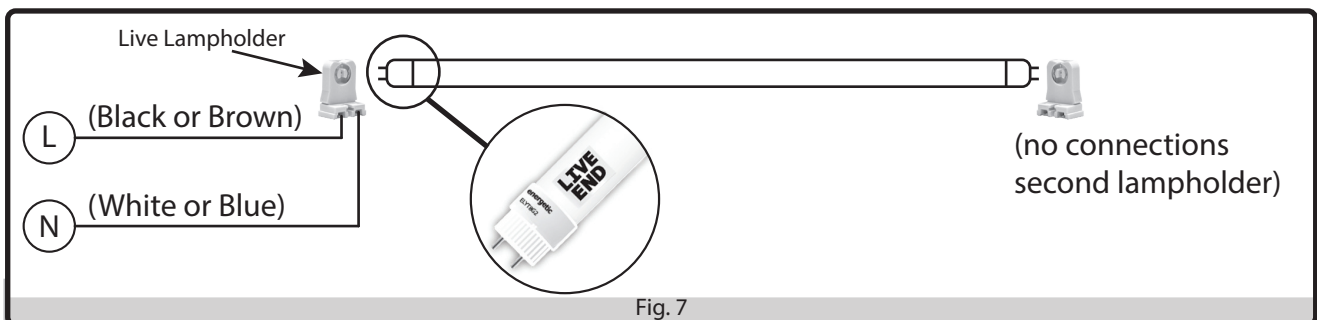

Fig. 7